

The Conference Center

at convention place

See page 8

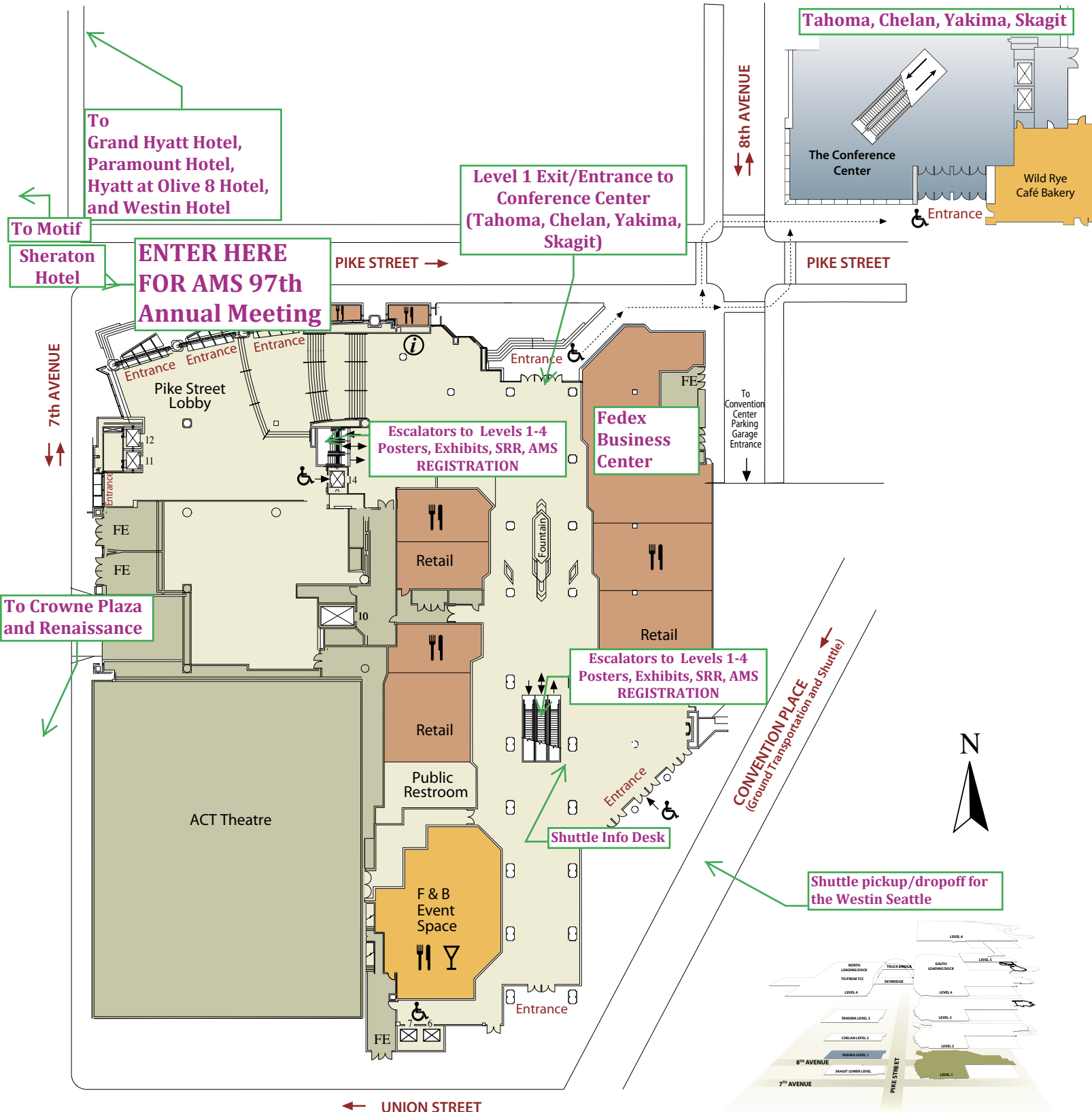

Washington State Convention Center Level Two: Meeting Rooms

Escalators down to level 1 and up to level 3 and 4 (AMS Registration, Exhibits, Posters, SRR)

Room 2AB:
Houze Symposium,
Observation Symposium,
Bosart Symposium

Rooms 201-210:
Exhibitor Use

Escalators down to level 1 and up to level 3 and 4 (AMS Registration, Exhibits, Posters, SRR)

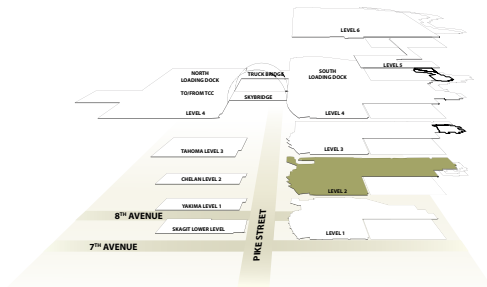

To Two Union Square



Washington State Convention Center Level Three: Meeting Rooms

Escalators down to level 2 and 1
up to level 4 (AMS
Registration, Exhibits,
Posters, SRR)

Room 3AB:
Women's Luncheon
(Tues) and Bosart
Luncheon (Thur)

Room 305:
Press Briefing Room

Room 304:
Press Briefing Room

Escalators down to
level 1 and 2
up to level 4 (AMS
Registration, Exhibits,
Posters, SRR)

Room 303:
Press and BAMS Operations

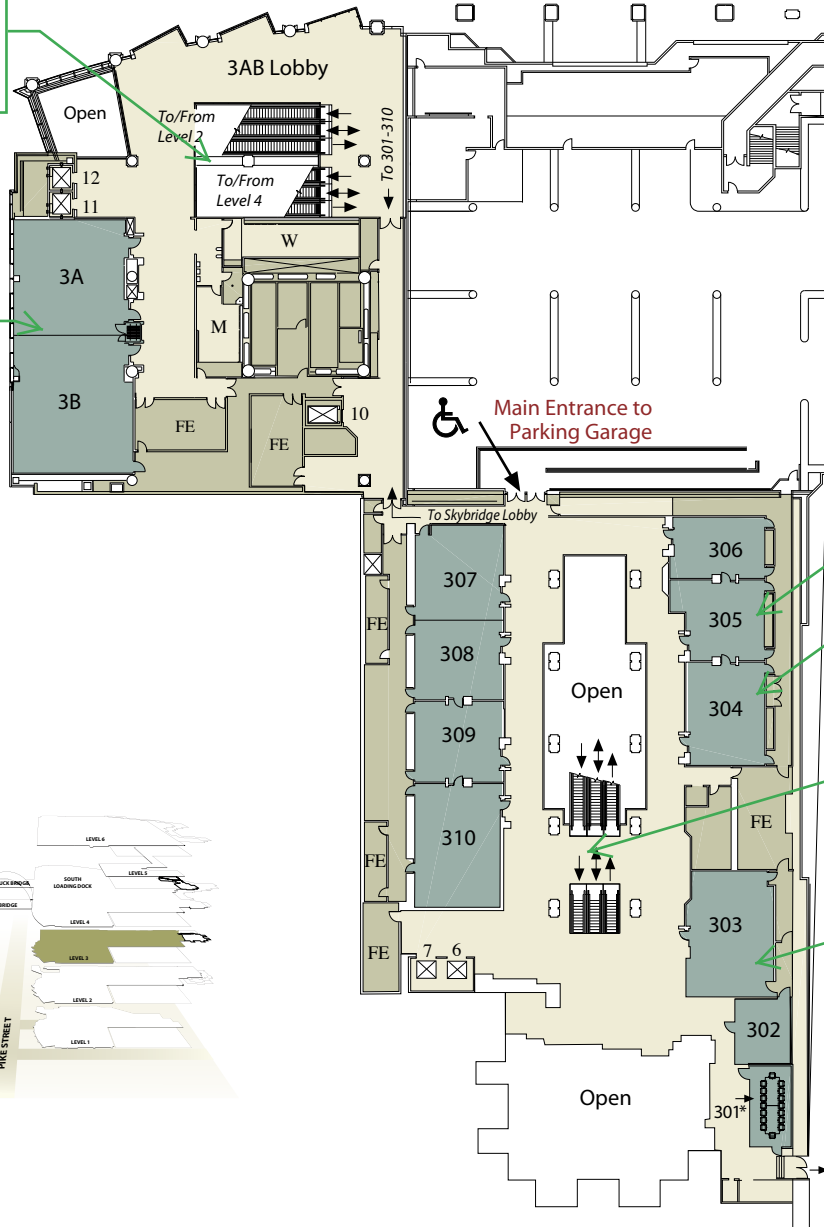
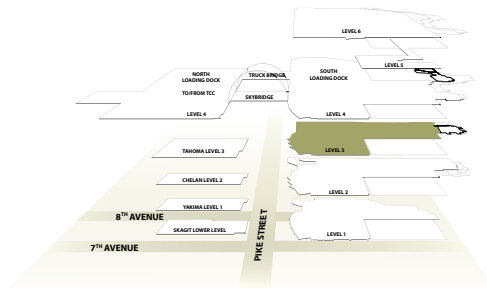

To Garages
and Freeway
Park Garage

Washington State Convention Center Level Four: Exhibition Halls

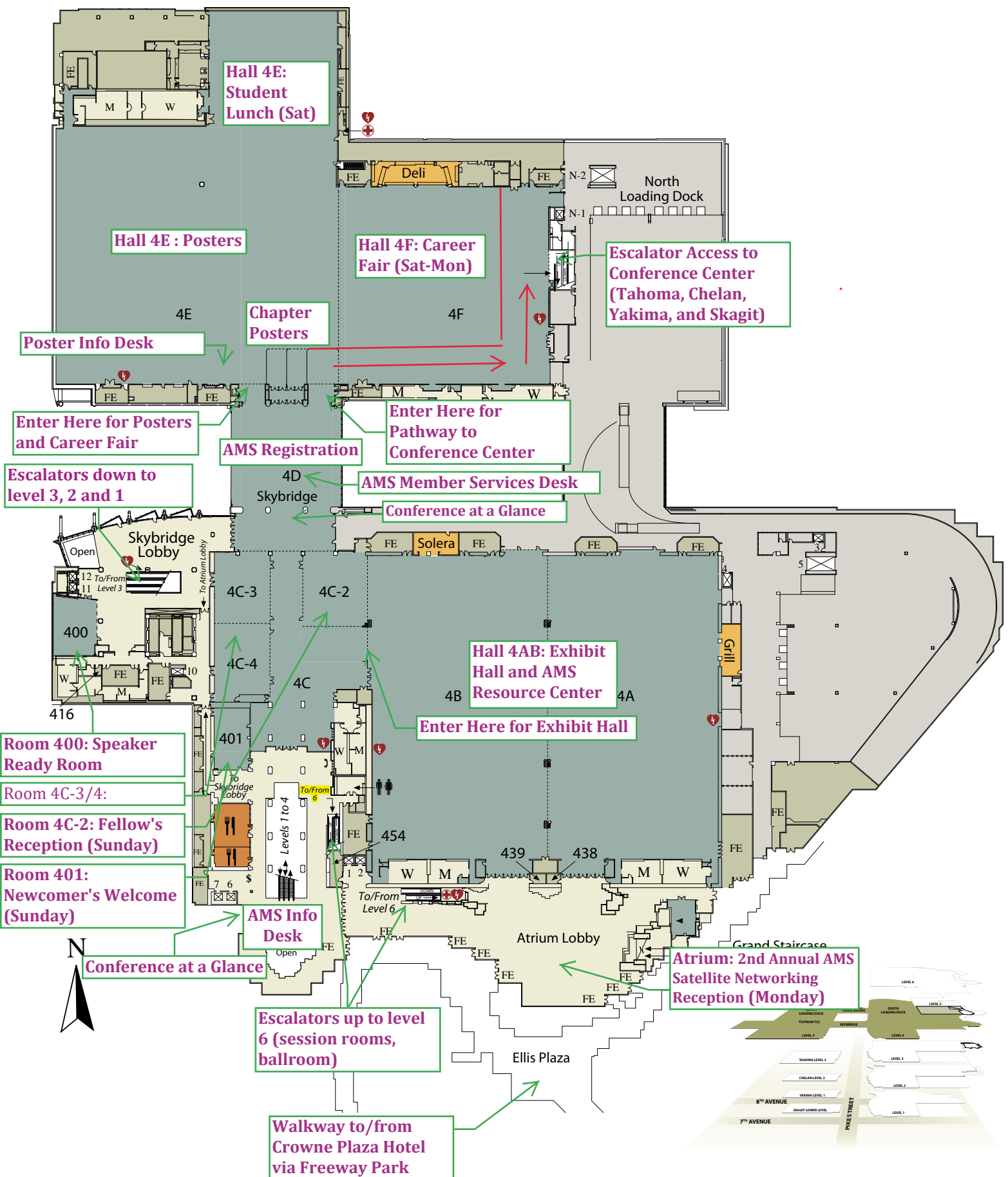

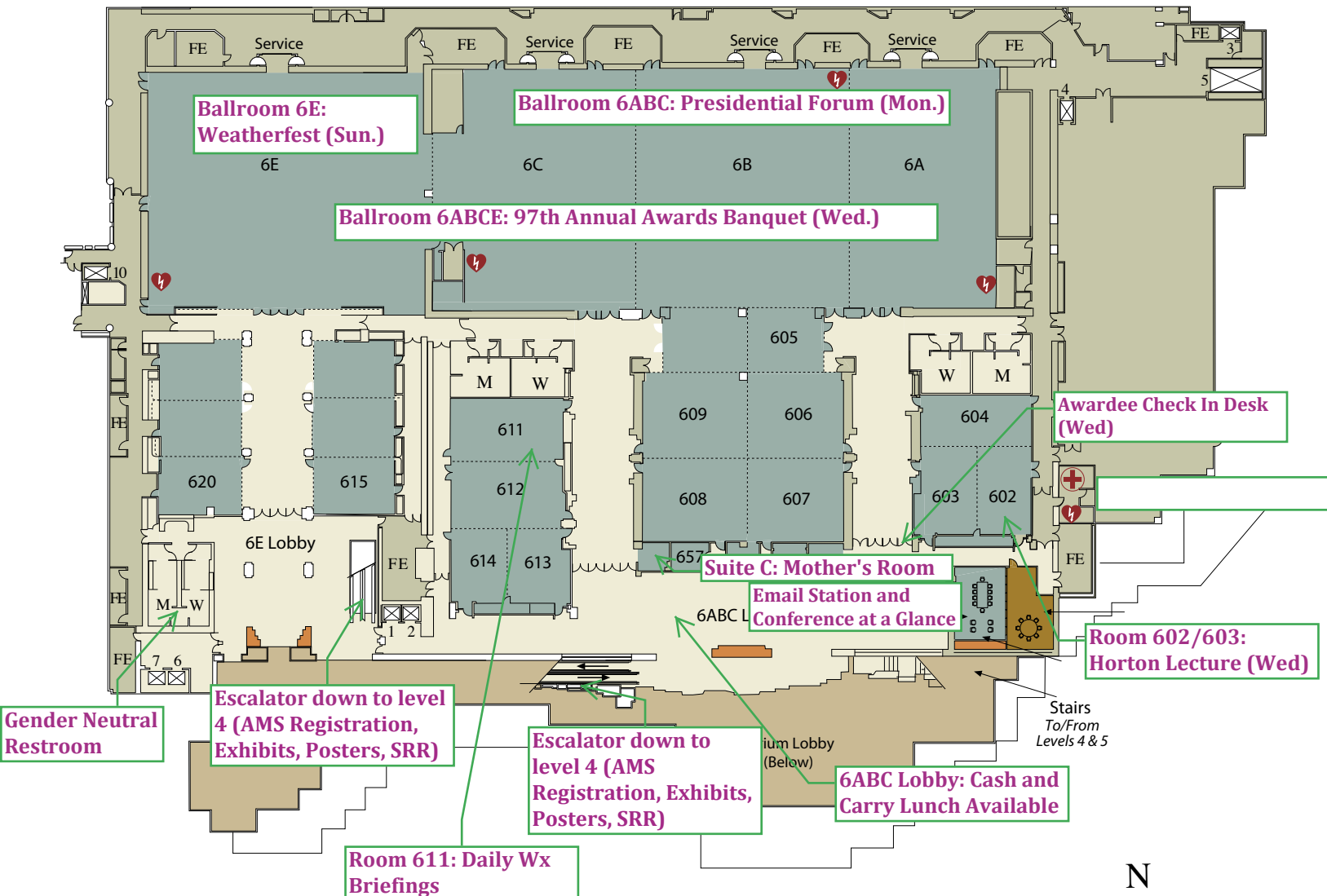

The Conference Center

Skagit Lower Level

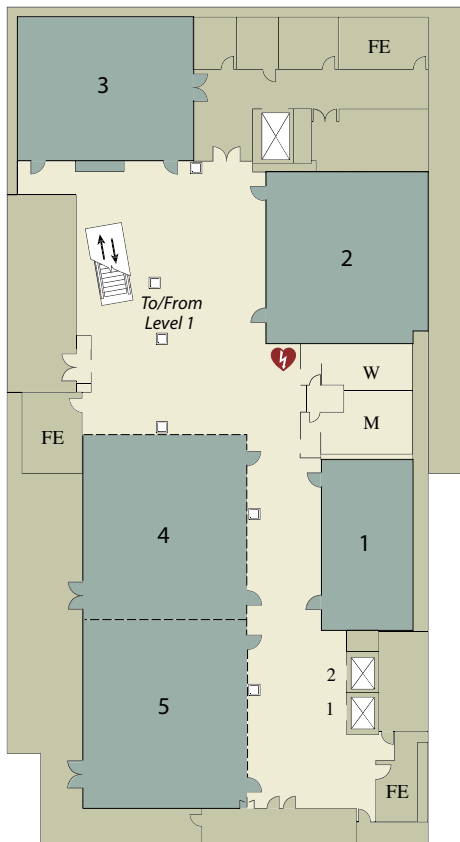

Yakima Level One

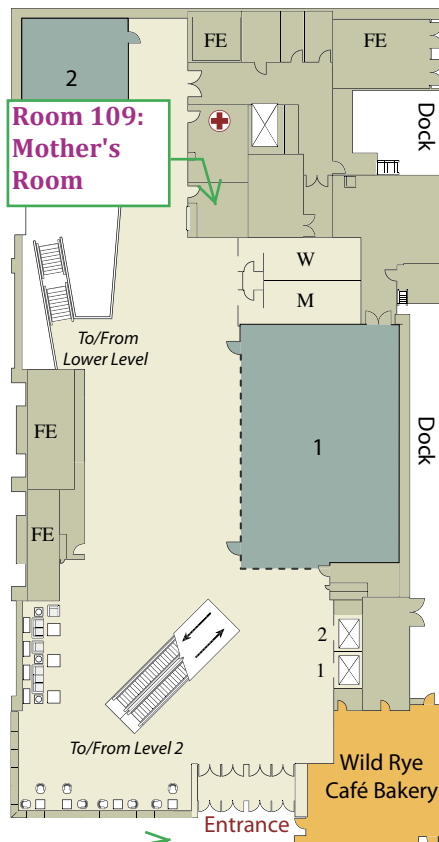

Room 109:
Mother's
Room

Chelan 4&5: Early
Career Conference
Breakouts (Sun.)

Chelan Level Two



Exit/Entrance to
Convention Center
(session rooms, AMS
Registration, Posters,
Exhibits, SRR)

PIKE STREET →

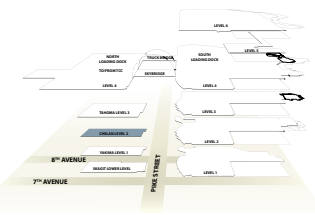
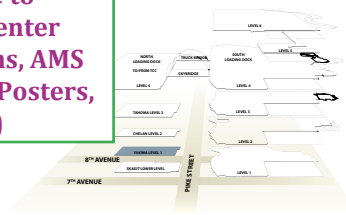
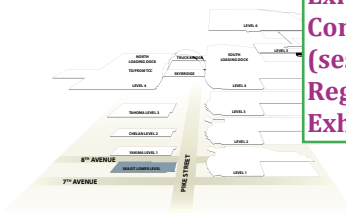

The Conference Center

Tahoma Level Three

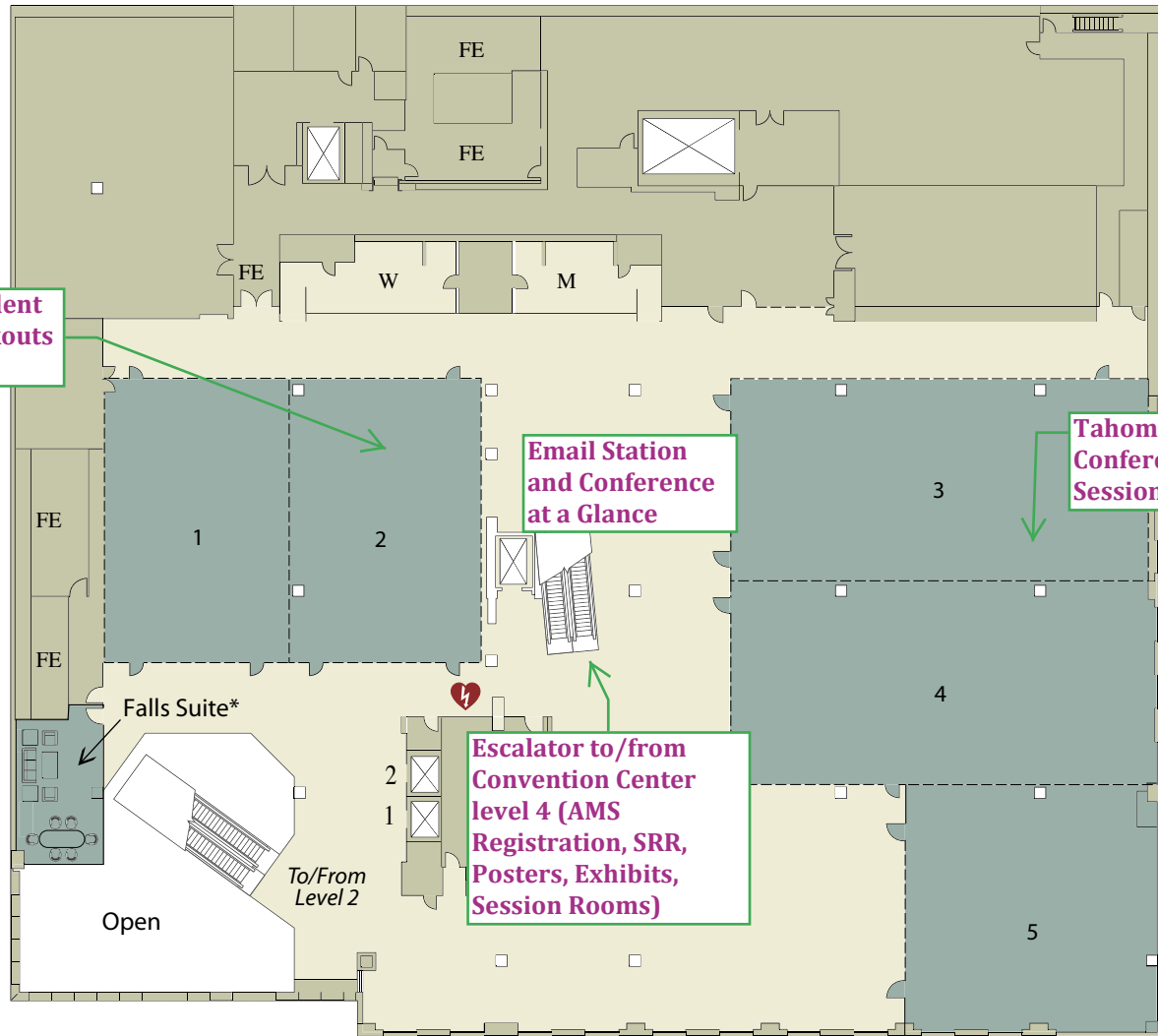

Tahoma 1/2: Student Conference Breakouts (Sat./Sun.)

Email Station and Conference at a Glance

Tahoma 3/4: Student Conference General Session (Sat./Sun.)

Escalator to/from Convention Center level 4 (AMS Registration, SRR, Posters, Exhibits, Session Rooms)



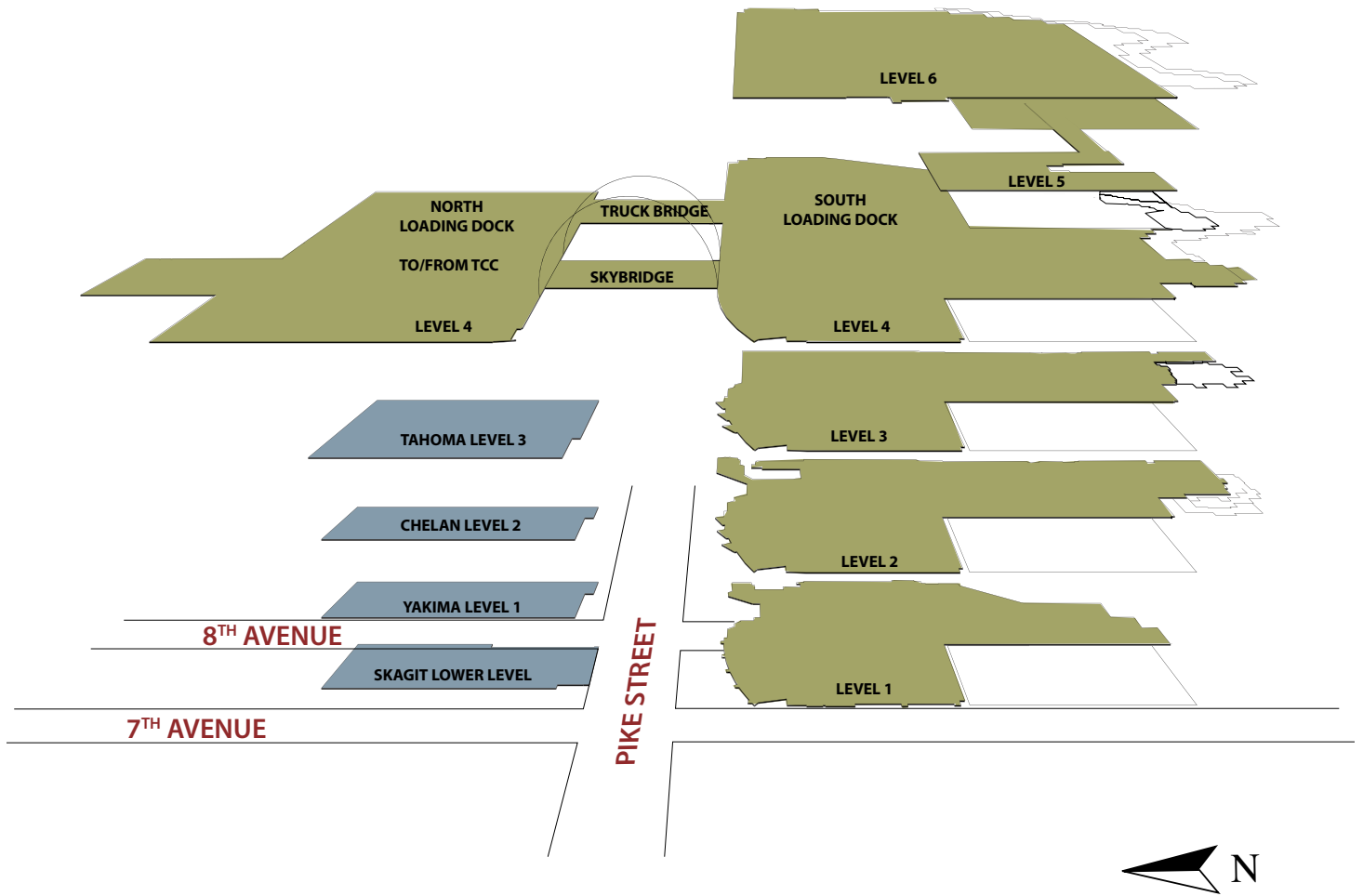

NOTES
